

iTrans USB2-TR50

50m USB 2.0 Extender Kit

User Manual V2.0



TABLE OF CONTENTS

1. INTRODUCTION.....	3
2. FEATURES.....	3
3. PACKAGE LIST.....	3
4. TRANSMITTER PANEL DESCRIPTION.....	4
5. RECEIVER PANEL DESCRIPTION	4
6. SYSTEM DIAGRAM.....	5

1. INTRODUCTION

Thanks for choosing the iTrans USB2-TR50 extender kit which consists of a transmitter (Tx) and a receiver (Rx). It serves as a 4-in-1 USB hub and extends USB 2.0 signal up to 50 meters over a Cat5e/6/7 cable.

The transmitter is powered by the computer and the power supply is at the remote receiver that's helps provide sufficient power to any type of USB device, such as flash drives, keyboards, mice, cameras, or printers, etc.

With its durable metal housing, this high-quality USB extender provides a fast and flexible solution for users. In addition, the compact size enables space-saving installation.

2. FEATURES

- High-Speed USB 2.0 compliant, the transfer data rate is up to 480Mbps.
- Transmission distance is up to 50m over a CAT5e/6/7 cable.
- Equipped with 4 USB peripherals to connect with keyboards, mouse, cameras and more.
- The first two USB-A ports provide 5V1A each, and the other two output 5V500mA each.
- Compatible with Windows, macOS and Linux.
- Plug and play.

3. PACKAGE LIST

- 1x Transmitter (TX)
- 1x Receiver (RX)
- 1x Power Adaptor (DC12V2A)
- 1 x USB-A male to USB-B male Cable (1m)

4. TRANSMITTER PANEL DESCRIPTION

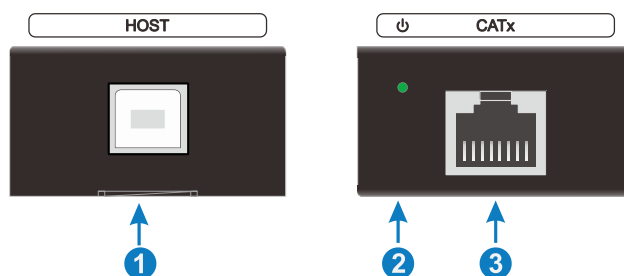

No.	Name	Description
①	HOST	Type-B USB port to connect with the computer.
②	Power LED	Illuminates green when the unit is powered on.
③	CATx	RJ45 connector for a CAT5e/6/7 Ethernet cable to connect the transmitter and the receiver.

5. RECEIVER PANEL DESCRIPTION

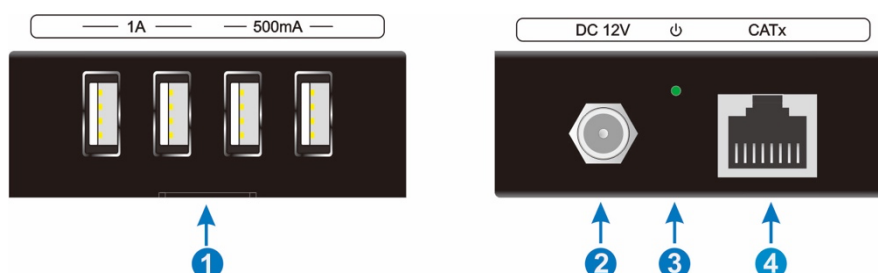

No.	Name	Description
①	USB Ports	Type-A USB ports to connect with keyboards, mouse, microphone, camera and more. The first two ports provide 5V1A each, and the other two output 5V500mA each.
②	DC 12V	DC barrel connector to connect the AC power adapter.
③	Power LED	Illuminates green when the unit is powered on.
④	CATx	RJ45 connector for a CAT5e/6/7 Ethernet cable to connect the transmitter and the receiver.

6. SYSTEM DIAGRAM

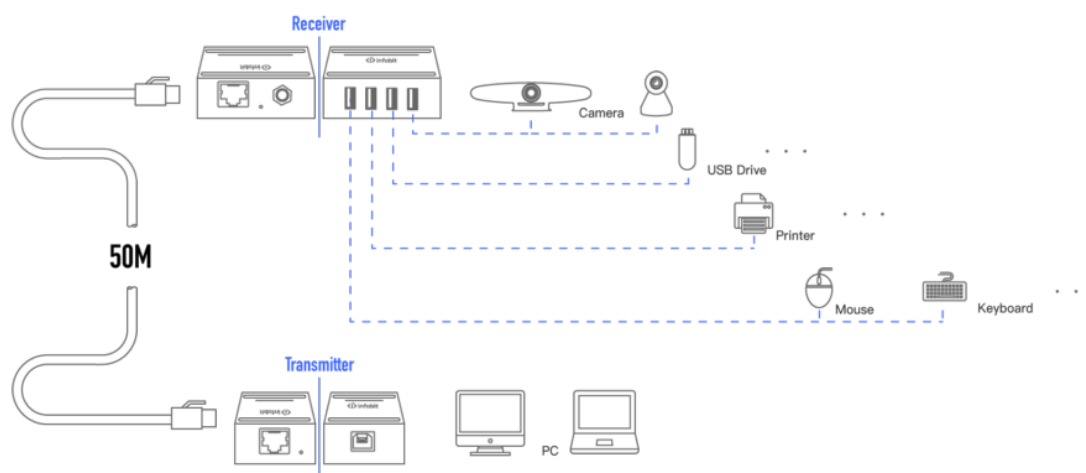

Note 1: This picture is for reference only. The specific scheme is subject to real devices.

Note 2: This transmission distance between TX and RX is affected by the followings:

- The lengths of USB cables.
- The number of USB HUB cascaded
- The type of Ethernet cable.