

ICAM VB80

All-in-One Conference Videobar with switcher and BYOD/BYOM

Datasheet V1.0



A. INTRODUCTION

The **iCam VB80** is an all-in-one meeting collaboration with ultra-wide angle 4K camera, microphone and speaker features, along with wired and wireless screen casting capability. It is ideal for applications for the huddle/small/medium rooms.

B. FEATURES

- Smart video conference collaboration with all-in-one solution of video speakerphone and camera.
- Wired screen presentation via USB-C (with DP) and HDMI.
- Wireless BYOD via Airplay, Miracast and Dongle (Dongle model: **iShare MC**).
- Wide angle 4K video camera with 120° FOV.
- 4x MEMS digital microphone arrays with a range of 5 ~ 8 meters and an angle of 180°.
- 2x 8W Stereo full range speakers with passive radiator bass enhancement.
- Includes **AEC** (Acoustic Echo Cancellation), **AGC** (Automatic Gain Control), **ANS** (Automatic Noise Suppression) and full duplex mode communication to make all participants feel like they are in the same room.
- Auto Framing / Speaker Tracking / Presenter Tracking based on AI technology makes meetings more intimate and friendly.
- Plug and play with excellent compatibility for OS and UC applications, such as Zoom, Teams, Webex, Skype, BlueJeans, etc.
- Provides flexible control options of Web GUI and Remote Controller.



- Built-in Wi-Fi.

C. PACKAGE CONTENTS

- 1x Video Bar
- 1x DC 24V Power Adapter
- 1x Remote Controller
- 1x Magnetic Lens Cap
- 1x Wall-mounted Bracket
- 1x Wall Hanging Bracket
- 4x Expansion Screws
- 4x Mounting Screws
- 1x mini USB to RJ45 adapter

D. SPECIFICATIONS

Audio and Video	
Interface	1x HDMI in, 1x HDMI out, 1x USB-C, 1x USB-B, 1x USB-A, 1x Mic, 1x GE, 1x DC
Video Resolutions	4K@30Hz (Max)
Output Video Encoding	MJPEG/YUY2/H.264/H.265 UVC 1.1

Camera and Sensor	
Lens	Fixed Focus
Sensor	CMOS, Effective Pixel: 8.0M
White Balance	Auto
Backlight Compensation	Auto
Digital Noise Reduction	2D, 3D Digital noise reduction supported
Viewing Angle	FOV: 120°
ePTZ	Supported 5 x Digital Zoom
HDR	Supported
Tracking Mode	Auto Framing / Speaker Tracking / Presenter Tracking

Speakerphone	
Microphone	4x Linear microphone arrays with echo cancellation Pick-up Range: 5m/16.4ft~8m/26.2ft
Speaker	2x 8W

Communication and Control	
HDMI	HDMI 2.0, HDCP 2.2
USB	USB-C: USB 3.0 host (60W max charging) USB-A: USB 3.0 device

Communication and Control	
	USB-B: USB 3.0 host
USB Protocol	UAC, UVC, USB HID
Ethernet	1 x RJ-45
WLAN	IEEE 802.11 a/b/g/n/ac
Control Method	Web UI, Bluetooth Remote Controller

General	
Operating Temperature	0°C ~ 40°C (32°F to 104°F), 10% to 90%, non-condensing
Storage Temperature	-20°C ~ 60°C (-4°F to 140°F), 10% to 90%, non-condensing
MTBF	> 30000h
Power Supply	DC 24V 5A
Power Consumption (Max)	100W
Dimension (Width x Height x Depth)	700mm x 126.83 mm x 90mm/27.56" x 4.99" x 3.54" (with Bracket)
Net Weight	2.42kgs/5.324lbs (with Bracket)
Gross Weight	6.22kgs/13.68lbs

E. PANEL DESCRIPTION

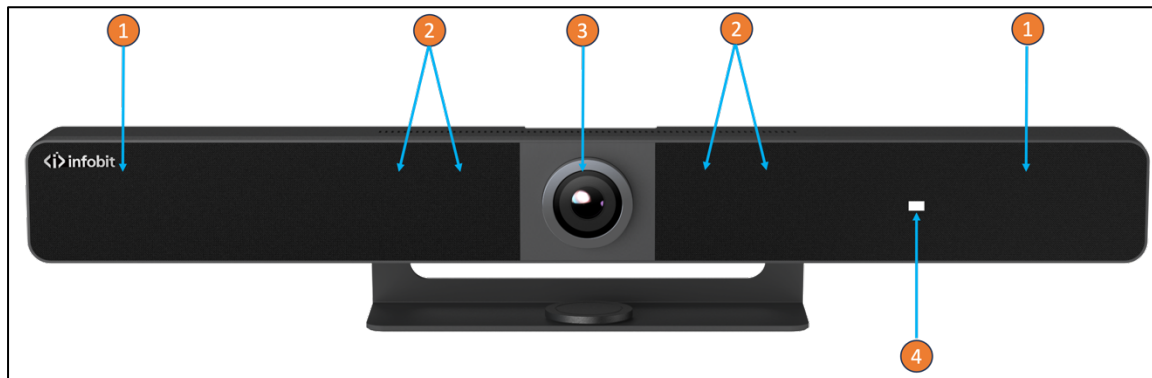

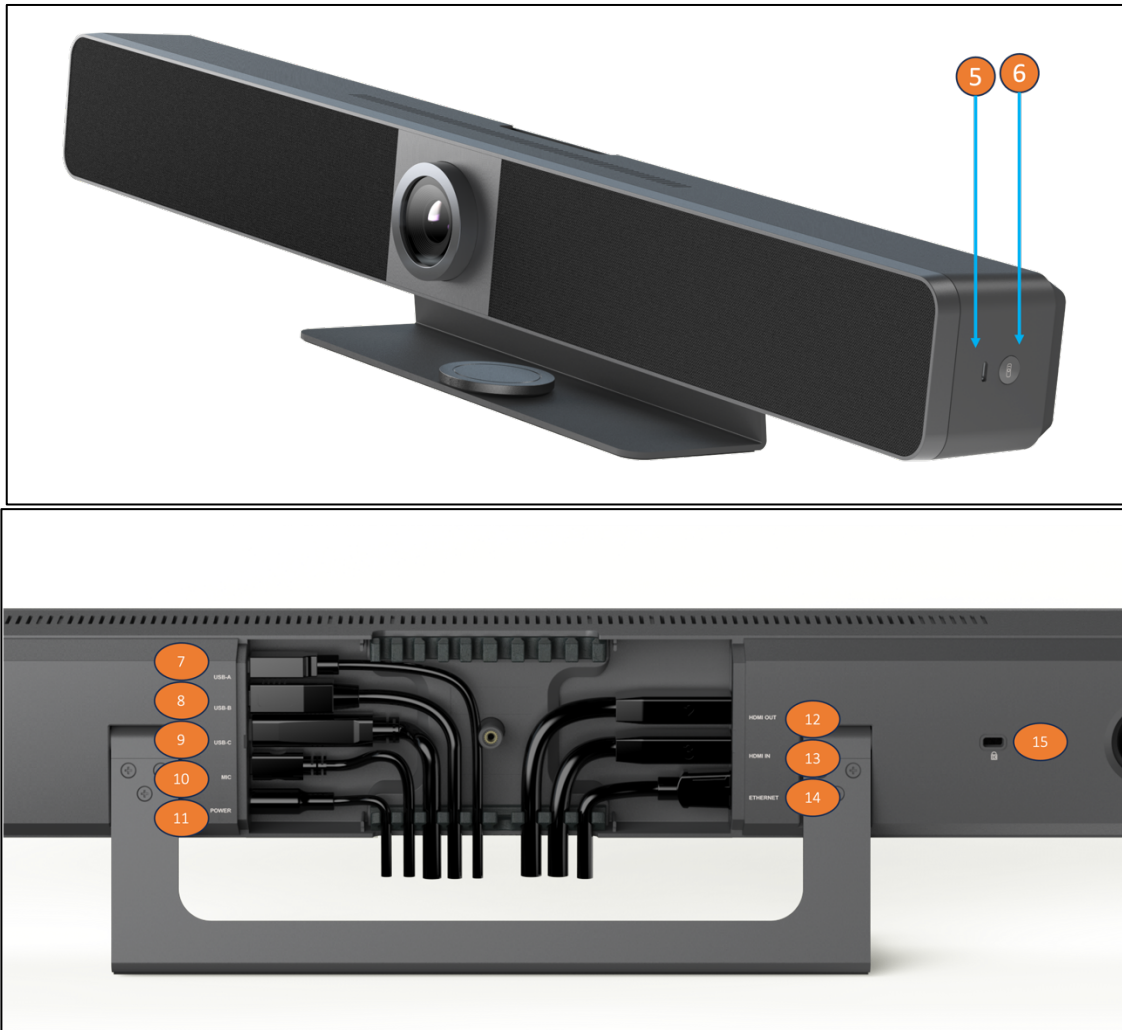

ID	Name	Description
1	Speaker	2x Speakers for audio signal output.
2	Microphone	4x Linear microphone arrays for picking up sound.
3	Lens	Camera lens.
4	Status LED	<ul style="list-style-type: none"> • Blinking orange: The device is booting. • Lighting white: The device is working properly. • Blinking white: The device is in standby state. • Blinking white very quickly: The device is being upgraded. • Breathing and lighting white: The device is in sleep state. • Lighting red: The device's microphone is muted. • Blinking blue: The device is in Bluetooth pairing state.
5	USB-C	Connect to the Dongle for pairing.
6	Pairing Button	Press and hold this button for more than 2 seconds to start pairing with the Bluetooth remote controller.
7	USB-A	USB 3.0 Type-A port. Connect to a USB device such as touch screen.

ID	Name	Description
8	USB-B	USB 3.0 Type-B port. Connect to the room PC for meetings.
9	USB-C	USB 3.0 Type-C port. USB PD: 60W max Connect to the laptop for meetings and presentation.
10	MIC	Connect to external microphone iCam VB80-Mic.
11	Power	Connect to the power adapter provided for DC 24V 5A input.
12	HDMI Out	Connect to a HDMI display device or a capture card of the room PC.
13	HDMI In	Connect to a laptop or PC.
14	Ethernet	Connect to a network device (e.g. network switch, wireless router, computer, etc.) for Airplay Mirroring signal input and LAN control (Web GUI & Telnet API).
15		Kensington security slot



• Blinking orange	The device is booting.
• Lighting white	The device is working properly.
• Blinking white	The device is in standby state.
• Blinking white very quickly	The device is being upgraded.
• Breathing and lighting white	The device is in sleep state.
• Lighting red	The device's microphone is muted.
• Blinking blue	The device is in Bluetooth pairing state.